

# BEACH FRONT LOT

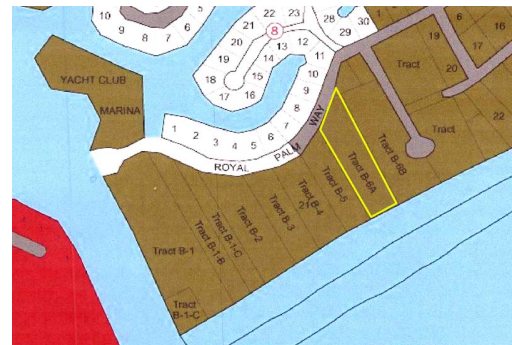

## 200 feet on the beach. The owner may consider joint venture

This magnificent 3.49 acre beachfront land is located on a gorgeous Lucayan beach and offers 200 linear feel of oceanfront. Ideal for a sizable development.

Complete development plans for 160 unit

Embassy Beach resort by Adache Architects in Ft. Lauderdale at cost of \$ 700,000...read more on our website.

Lot Size: 3.49

Maint. Fees: -

Subdivision: Bahama Reef

Yacht and Country Club

Features: Beach access,  
Ocean front



Ina Simmons

Phone: 242-727-0707

inasimmons@gmail.com



**\$2,900,000 ID# 5677** [View Online](#)  
**[www.sarlesrealty.com](http://www.sarlesrealty.com)**