

HAROLD ROAD 1-ACRE LOT, Harold Road, New Providence/Paradise Island

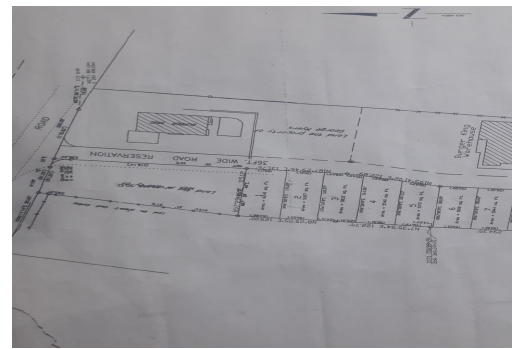
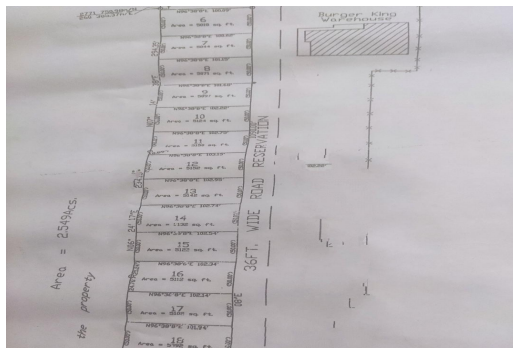

Harold Road multi-family 1 acre property for sale! This prime acreage is nestled just southwest of...

Harold Road multi-family 1 acre property for sale! This prime acreage is nestled just southwest of the Burger King restaurant off the Tonique Williams-Darling/Harold Road highway and is ideal for a small private subdivision. This central location offers easy access to private and public schools, medical services, shopping, restaurants and beaches....read more on our website.

- Bedrooms: 0
- Bathrooms: 0
- Lot Size: 43560
- Subdivision: Harold Road
- Features: Acreage, Central location, Easy Access, Highway Access, Level Lot, No Thru Road, None

HAROLD ROAD 1-ACRE LOT,
Harold Road, New Providence/Paradise Island
Phone:

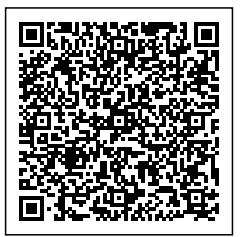

\$500,000 ID# 56631 [View Online](#)
www.sarlesrealty.com