

a QUEENS HIGHWAY, Other Exuma, Exuma & Exuma

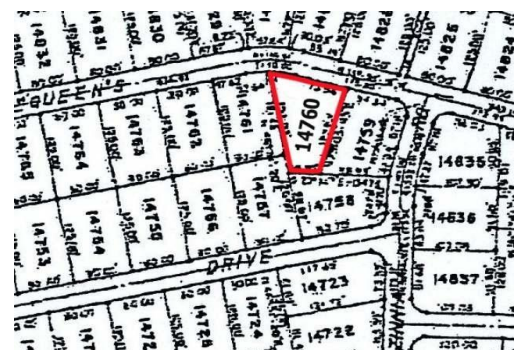

Multi dwelling vacant lots are situated going towards Emerald Bay. This property is actually open...

Multi dwelling vacant lots are situated going towards Emerald Bay. This property is actually open zoning and can be used for commercial purpose. This property is ideal for a shopping centre or a small business and is centrally located not far from the Sandals Resort and Emerald Bay Marina. The property adjacent is also for sale....read more on our website.

Bedrooms: 0

Bathrooms: 0

Lot Size: 11000

Subdivision: Other Exuma

Features: Golf Course

Nearby, Highway Access,

Marina Nearby, None,

Road - Gravel, Shopping

Nearby

Exuma QUEENS HIGHWAY,

Other Exuma, Exuma &

Exuma Cays

Phone:



\$70,000 ID# M60101 [View Online](#)
www.sarlesrealty.com

Ph: (242) 351-9081 | Web: www.sarlesrealty.com