

# WATERFRONT PROPERTY #9, Rainbow Bay, Eleuthera

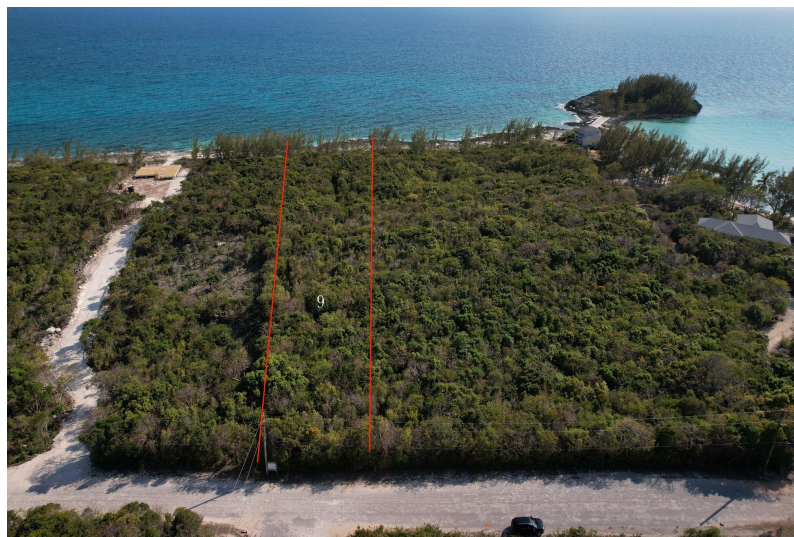

## Discover the perfect opportunity to build your dream home on this 1.205-acre waterfront property in...

Discover the perfect opportunity to build your dream home on this 1.205-acre waterfront property in the Rainbow Bay community. Situated on the serene Caribbean side of Eleuthera, this property offers breathtaking panoramic views of the turquoise sea and mesmerizing sunsets. Residents of Rainbow Bay enjoy access to multiple pristine beaches, including the renowned Rainbow Bay Beach, known for its clear, calm waters ideal for swimming and snorkeling. The community is well-organized, with properly labelled roads and amenities such as a tennis court. Conveniently located just a 15-minute drive from Governor's Harbour Airport, this lot offers an excellent opportunity to embrace the tranquil island lifestyle....read more on our website.

Bedrooms: 0

Bathrooms: 0

Lot Size: 52490

Subdivision: Rainbow Bay

Features: Acreage, None,

View - Ocean, Waterfront

- Ocean

WATERFRONT PROPERTY #9,

Rainbow Bay, Eleuthera

Phone:



**\$265.000 ID# M61883** [View Online](#)  
[www.sarlesrealty.com](http://www.sarlesrealty.com)