

Nassau-Ocean Front

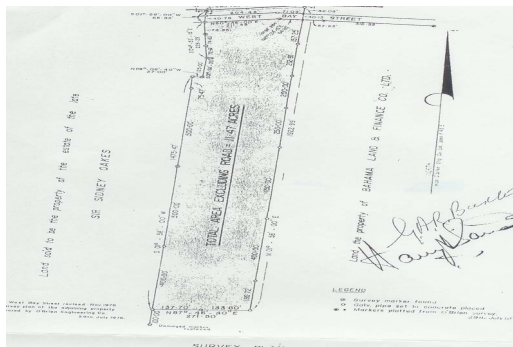

Prime hilltop, oceanfront property, ideal for development, private estate or business complex.

Prime hilltop, oceanfront property, ideal for development, single family lots, private estate or business complex. Conveniently situated in prime location on West Bay Street, approximately 15 minutes from downtown, Nassau....read more on our website.

Lot Size: 17.0
Maint. Fees: -
Features: Ocean front



James Sarles

Phone: (242) 727-8888
jamesarlesrealty@gmail.com



\$4,000,000 ID# 4008 View Online
www.sarlesrealty.com