

Bootle Bay Land

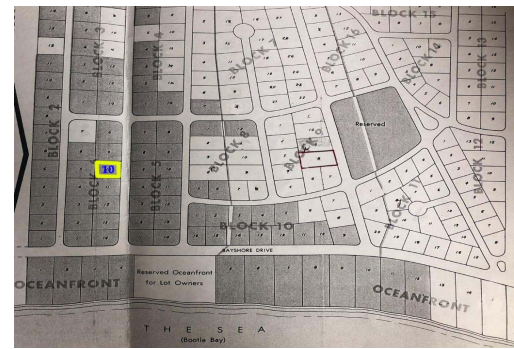

Single family lot very close to the beach

This 10,000 sq. ft. (0.22-acre) single-family residential lot is ideally situated just a few hundred yards from a pristine white sand beach in the growing Bootle Bay Subdivision. Located on Bimini Road, this property offers an excellent opportunity to build your dream island home in a peaceful and developing community.

With no annual land service charges, ownership remains affordable while preserving the long-term value of your investment. A future two-story residence could capture beautiful ocean views, creating an added lifestyle benefit and enhancing the property's appeal.

Bootle Bay is conveniently located near West End, Grand Bahama's renowned "Conch Capital," where you'll enjoy easy access to...read more on our website.

Lot Size: 0.22
 Living Area: 10,000
 Subdivision: West End /
 West Grand Bahama



Nycara Saunders

Phone:

nycara.saunders@gmail.com



\$56,150 ID# 5353 [View Online](#)
www.sarlesrealty.com