

Long Beach PRINCESS STREET, Long Beach, Abaco

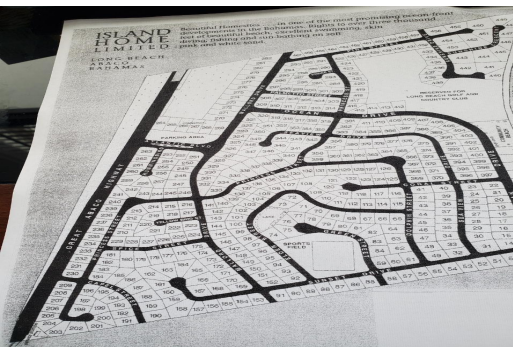

Long Beach Lot 415 is a vacant level 11,887 sq. ft. pie shaped lot with 148 feet on the road and...

Long Beach Lot 415 is a vacant level 11,887 sq. ft. pie shaped lot with 148 feet on the road and narrowing to 8 feet wide at the back. The northern side is 148 feet deep and the SW side is 183 feet deep. Long Beach subdivision is 35 miles south of Marsh Harbour. Adjoining Lot 416 (10,000 sq. ft.). The residential community offers underground electricity, city water and a community Beach accessing a powder white 4 mile long Beach. There is a \$15,000 one time fee to connect to City Water once you start to build. This fee can be paid in three equal payments during the construction phase. Thereafter, water usage is billed quarterly by the Water & Sewerage Corporation....read more on our website.

Bedrooms: 0

Bathrooms: 0

Lot Size: 11887

Subdivision: Long Beach

Features: Can Be Rented,

Easy Access, Family

Oriented, Highway

Access, Level Lot, No

Thru Road, None, Pets

Allowed, Quiet Area

Long Beach PRINCESS

STREET, Long Beach, Abaco

Phone:



\$20,000 ID# M47927 View Online
www.sarlesrealty.com