

BAHAMA ISLAND BEACH #2, Little Exuma, Exuma & Exuma

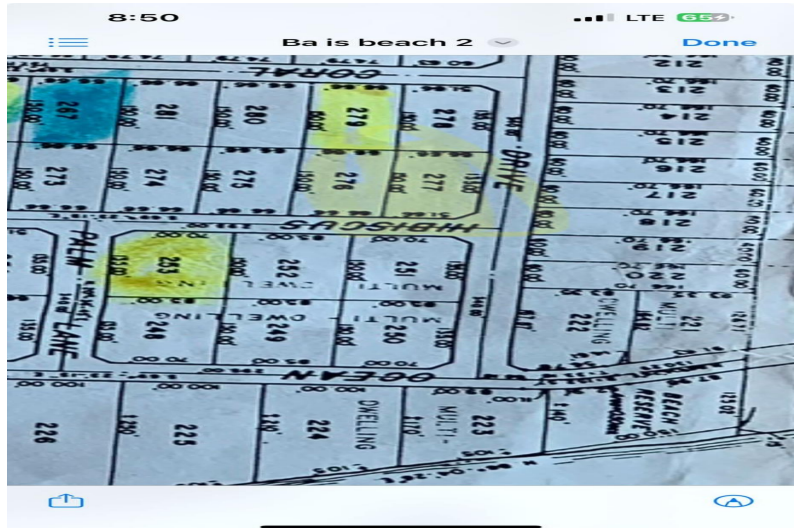
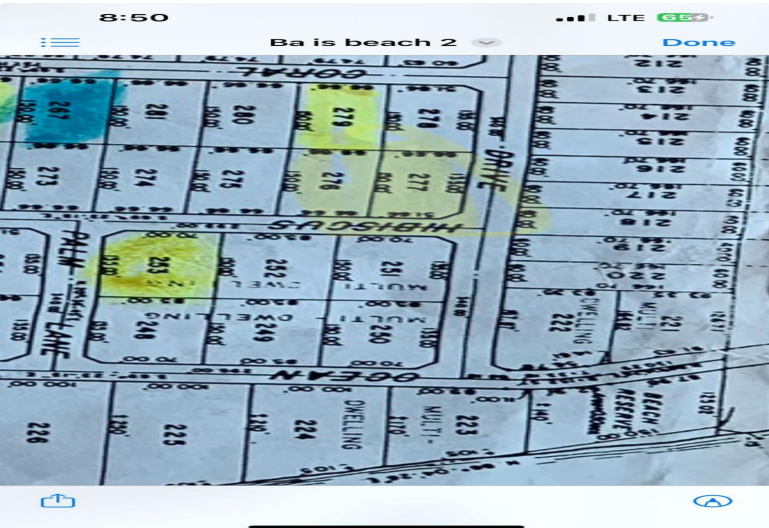

Experience the perfect blend of serenity and convenience in this exceptional corner lot, ideally...

Experience the perfect blend of serenity and convenience in this exceptional corner lot, ideally situated just one block from the world-renowned Tropic of Cancer Beach. This prime location puts you steps away from pristine white sand while offering the privacy and tranquility of Island living. The property is nestled in a rapidly developing area with a surge of upscale residential homes under construction, indicating strong property value appreciation potential. Lot dimensions: 66 ft. X 150 ft. (9,900 sq. ft.)...read more on our website.

Bedrooms: 0
 Bathrooms: 0
 Lot Size: 9900
 Subdivision: Little Exuma
 Features: None

BAHAMA ISLAND BEACH #2,
 Little Exuma, Exuma &
 Exuma Cays
 Phone:



\$140,000 ID# M60315 [View Online](#)
www.sarlesrealty.com